

Ground-Level Offices



General Specifications

- Low set up and freight costs
- Multiple 20' offices can be shipped on one truck
- Units can be relocated on-site if needed
- Units can be stacked when space is limited
- Desks, shelves, file cabinets and planning tables can be added
- HVAC system included
- Paneled walls & tiled floors
- 40' offices available with 1 or 2 exterior doors

Common Uses for GLOs

- Offices
- Storage
- Guard Shacks
- Gate Houses
- 911 Centers
- Contractor Offices
- Meeting Rooms
- Break Rooms

Satellite Shelters, Inc.

Don't be frustrated by lack of quality space. Get peace of mind with simplified modular space solutions. Request A Quote. Choose A Building. Enjoy Your New Space. Because everyone deserves safe, quality work space.

Flexible Financing

We have rental, lease and purchase options to fit your needs.

*Building exteriors and interiors may differ based on region. For more information, contact your local Satellite office.

**8 x 20
GLO**

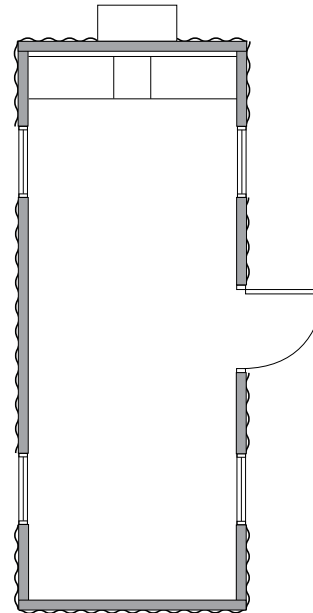

**8 x 40
GLO**

